

Access and Egress for local residents to be maintained by MWS

Llqad-Enwyn

Sign Schedule	
	ID: 001 Qty: 2 Ref: 13.9 Schedule 13-9 : Temporary Information Size: 849 x 1175 @ 50 X-Hgt
	ID: 002 Qty: 2 Ref: 511 Reduce speed now Size: 917 x 938 @ 75 X-Hgt
	ID: 003 Qty: 2 Ref: 13.9 Schedule 13-9 : Temporary Information Size: 849 x 925 @ 50 X-Hgt
	ID: 004 Qty: 2 Ref: 7001 Road works ahead Size: 750 High

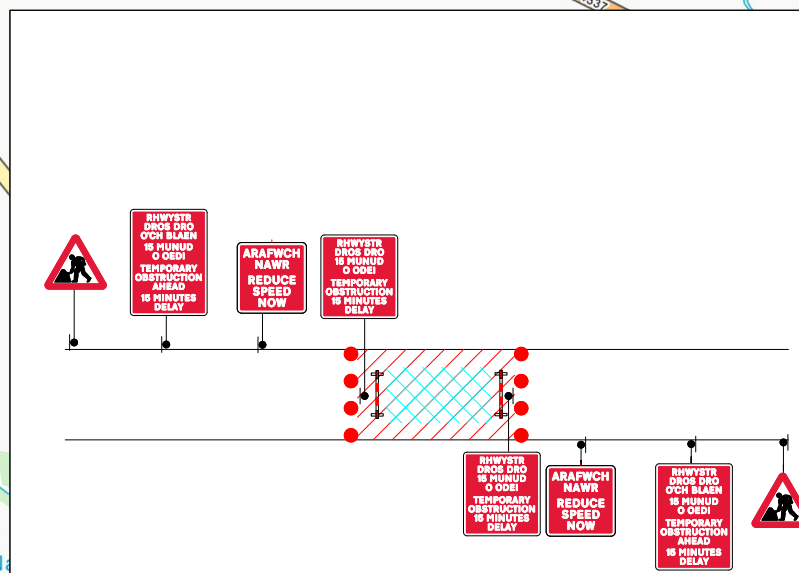

TRAFFIC MANAGEMENT NOTES:
 1) All temporary traffic management shall be in accordance with Chapter 8 of the Traffic Signs Manual.
 2) All temporary traffic management shall be in accordance with the Traffic Signs Regulations and General Directions 2016.
 3) All temporary traffic management shall conform to the Safety at Street Works and Road Works, A Code of Practice.
 4) All signing should be located 450mm minimum from any carriageway.
 5) All temporary traffic management sign locations are indicative and are subject to on site approval from the Engineer.

Checked by: Adrian Crees

Customer: MWS LTD

Job reference: 96662210

Location: NANT HELYG
Llanybydder
SA40 9SA



Date: 21/10/2024

Description: T015

Scale: NTS OS HA: 0

0330 043 3030
www.corehighways.com

Produced by: Ash Williams

Design reference: ADW/21.10.24/J127386

This Design is subject to Copyright and remains the property of Core Highways.
Contains Ordnance Survey data.

